

EN

SE

DE

FR

# TORMEK<sup>®</sup> T-2

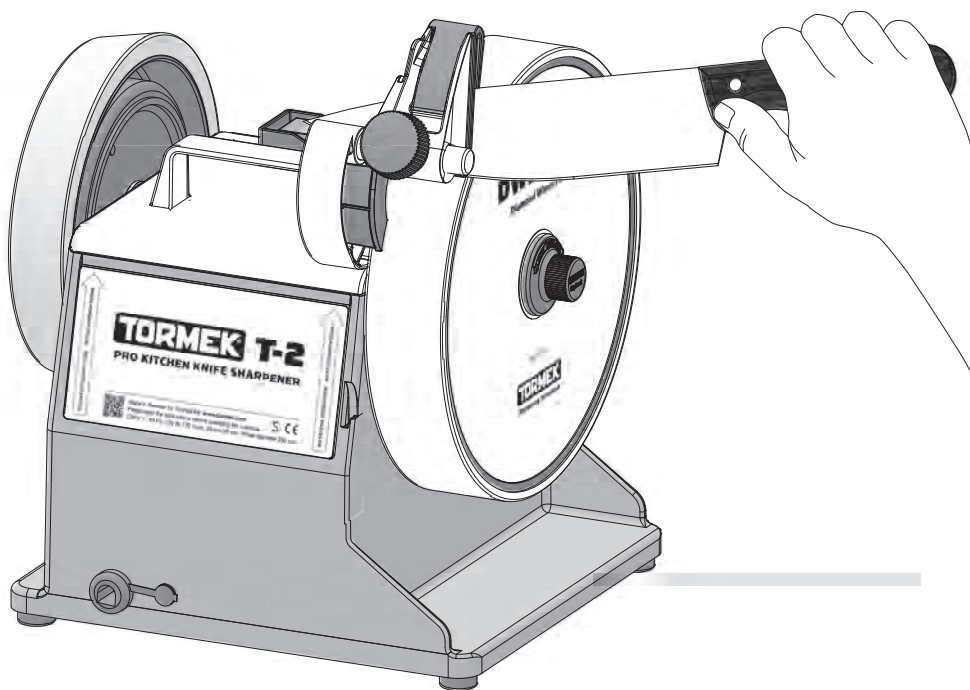

# Knife sharpening for the professional kitchen

The Tormek T-2 Knife Sharpener has been made to meet the professional kitchen's need for an efficient workflow and effective sharpening. The concept is a further development of the diamond bench stone, which in combination with the control of the edge angle makes it possible to easily achieve a professional sharpening, right when and where needed.

**Machine Measurement:** Width 240 mm, Depth 210 mm, Height 285 mm.

**Machine Weight:** 6.3 kg **Grinding Wheel:** Tormek Diamond Wheel Fine DWF-200,  $\varnothing$  200 x 40 mm, 120 rpm, torque 8.4 Nm. **Honing Wheel:**  $\varnothing$  160 x 30 mm

**Housing:** Zinc cast top, Impact resistant ABS plastic **Motor:** Industrial single phase, 120 W (input) 230 V, 50 Hz or 115 V, 60 Hz, duty 30 min/hour, maintenance free, silent running 54 dB, 10,000 hour life. **Warranty:** 7 years. When used for a professional sharpening service the warranty is 2 years.

Handle  
knife sizes:



Width  
14–60 mm  
( $\frac{1}{16}$ " –  $2\frac{3}{8}$ " )



Thickness  
Max 3.5 mm  
( $\frac{3}{32}$ " )

## Getting started

### 1. Mounting the diamond wheel

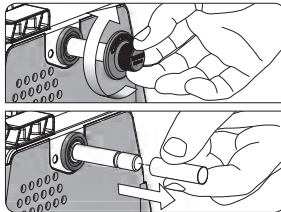

Remove the packing sleeve – turn the left hand thread EzyLock nut clockwise by hand.

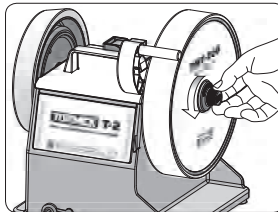

**Mounting:** Put the wheel onto the shaft and turn the EzyLock anticlockwise by hand. When sharpening, the grindstone will automatically tighten to the correct torque.

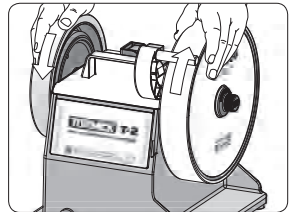

**Dismounting:** Turn the wheel clockwise by hand whilst holding the honing wheel still, and the EzyLock washer nut will automatically become loose.

### 2. Mounting the Honing Wheel

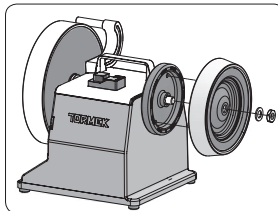
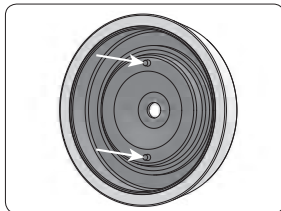

Make sure the pins on the honing wheel locate into the holes on the drive wheel.

### 3. Mounting the clamp

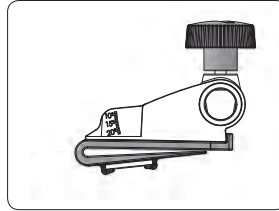
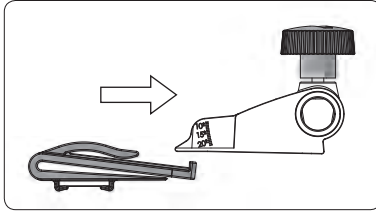

### 4. Mounting the pointer

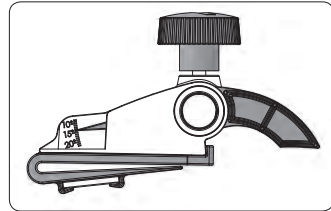
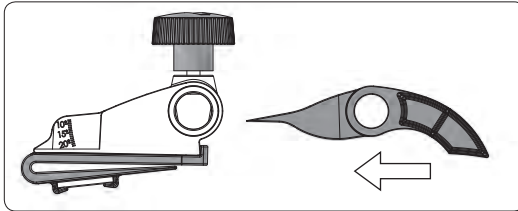

### 5. Positioning the jig on the axis

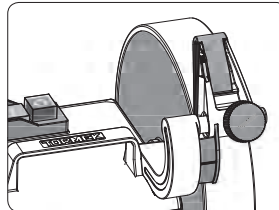
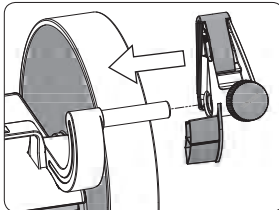

## Important information regarding the diamond wheel

Always clean the knife before sharpening, otherwise the function of the grinding wheel can be altered.

At first usage, the diamond surface will seem aggressive but after a short break-in period, the diamond crystals will stabilise to a uniform level to give a finer surface. This normally takes 2-5 sharpenings.

Clean your sharpener after usage with water, washing-up liquid and a nylon brush. Store the machine in a dry area.

# Sharpening instructions

## 1. Set the desired edge angle

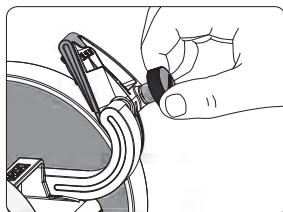

15° setting will give  
a 30° cutting angle.

**Tip** You will save time and prolong the life of your knives by repeating the same edge angle. Then you will only need to remove a minimal amount of steel each time.



### Suggested edge angles

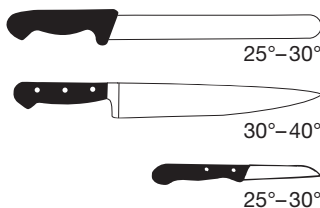

*Example edge angle and result.*  
A common angle for a kitchen knife is 30°, so set the pointer at a 15° sharpening angle on each side which will give you a 30° result on your knife.

### Which edge angle?

Generally, a smaller edge angle gives a sharper edge whilst a larger edge angle is stronger and longer lasting. For example, a knife that will be used for meat should have a larger edge angle than a thinner fillet or vegetable knife. The composition of the steel will also affect which angle is most suitable. A high quality knife blade generally maintains sharpness at a smaller edge angle compared to a knife blade of low quality steel.

Japanese knives are sharpened with a slightly smaller angle compared to European knives. If the knife is only sharpened on one side, a suitable edge angle for that side can be 20°–25°.

## 2. Position the knife and start sharpening

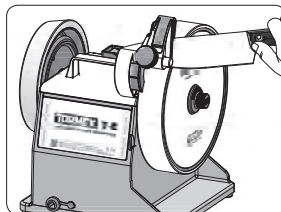
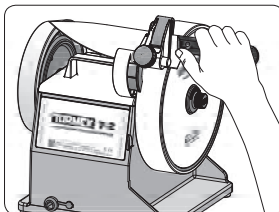
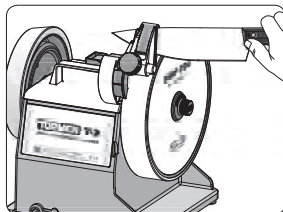

First, make sure the knife is clean. Start the machine. Position the knife in the jig and move it down towards the grinding surface. Slide the knife evenly over the grinding wheel applying a light pressure. Ensure that the knife is in contact with the full width of the wheel. Follow the shape of the knife. Let the jig guide determine the angle. 2–3 sweeps are normally enough if you sharpen at the same angle as previously.

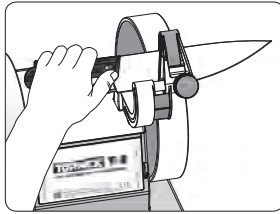

Sharpen the other side in the same way.

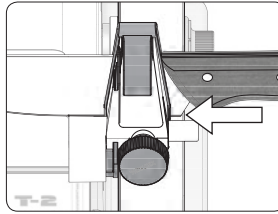

If the knife handle is in the way – loosen and move the jig a little so the knife blade can run effortlessly towards the wheel.

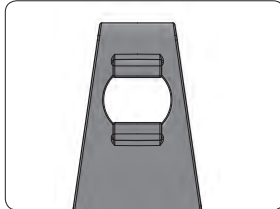
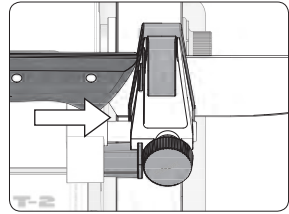

To help keep the diamond sharpening wheel clean, a magnet is attached to the back side of the jig. It collects steel particles during sharpening.

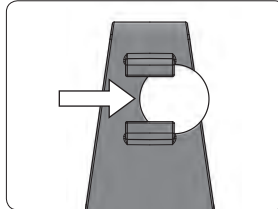

If you feel that the magnet interferes your sharpening (some knives tend to stick to it) you can easily remove it.

**Note** Sharpening dust can sometime result in small scratches on the knife blade. You can use the included protective papers to avoid this, see p. 33 for instruction.

### 3. Hone to final finish

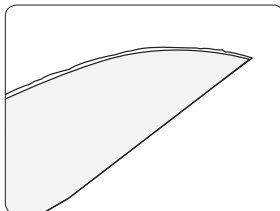

After sharpening, a “burr” is created. It needs to be honed away in order to get a sharp edge that will not break in use.

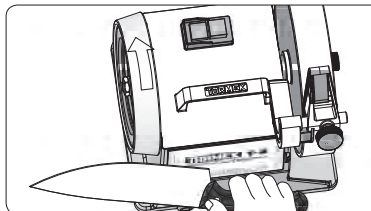

Before you start honing, make sure that the honing wheel rotates **away from** the edge, otherwise the knife will cut into the wheel.

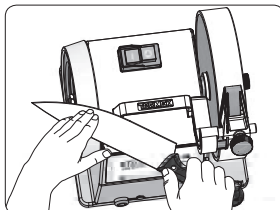
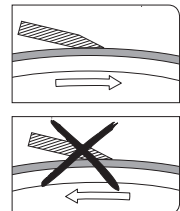

Move the knife sideways with a light pressure. Pay close attention so you do not apply an angle too steep or you will dull the edge. A couple of strokes on each side is usually enough. Now you have a sharp knife!

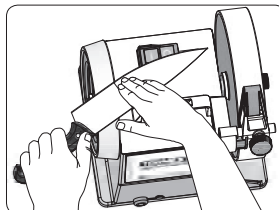

The burr can sometimes (depending on the quality of the steel) bend to one side and then the other, therefore it is sometimes better to hone alternately between the sides.

If the burr is not honed away, the knife can feel dull, even though it is “freshly sharpened”.

# Safety

## Grinding and Sharpening

- Tormek T-2 is designed for knife sharpening. Only use the machine for the purpose it is designed for. Follow the instructions.
- Only use Tormek original accessories. Use of other accessories than which are recommended can be a danger for the user.
- The Tormek jigs and accessories are especially designed for Tormek machines and must not be used on any other grinder.
- Do not force the machine. It will do the job better and safer at the rate for which it was designed.
- Make sure your hands are dry and clean from grease and oil.
- Do not wear loose clothing, gloves, neckties, rings, bracelets etc., which can get caught in the moving parts.
- Keep long hair covered or tied back. Non slip footwear is recommended.
- Keep a secure footing and balance when working with the machine.
- Avoid body contact with earthed objects (e.g. pipes, radiators, refrigerators, stoves etc.).
- Keep your hands and fingers away from the area between the jig and the grinding wheel.
- Ensure that you have full control of your work. Use common sense and do not use the machine when you are tired.

## Condition of the Machine

- Before using the machine it should be checked to determine that it will operate properly and perform its intended function. Do not use the machine if the switch does not turn it on and off.
- Inspect the cord set periodically. If damaged, have it exchanged by qualified personnel. This is also valid for an extension cable if used.
- Disconnect the machine from the power supply before servicing and when changing the grinding wheel or the honing wheel.
- Only use Tormek original grinding wheels intended for model T-2. Max. diameter 200 mm and max. width 40 mm. Hole diameter 12 mm.
- Do not snatch the cable when pulling it out from the socket. Ensure that the cable is kept away from sharp edges, oil or heaters.

## Place of Work

- Connect the machine to an earthed power supply with the voltage and Hz, which is written on the machine shield.
- If you use the machine outdoors and if you use an extension cable, the extension cable must be approved for outdoor use.
- Do not use the machine close to inflammable gases or liquids or in a dangerous environment, e.g. wet locations and do not expose it to rain.
- Ensure that any tools (e.g. spanners or adjustable wrenches) are removed from the grinding machine before turning it on.

- The machine should be operated on a flat, stable surface. Keep work area clean. Cluttered areas and benches invite accidents. Keep work area well lit.
- All children or visitors should be kept at a safe distance from the work area.
- Make workshop kid proof with padlocks or master switches.

### Grounding Instructions

- In the event of a malfunction or breakdown, grounding provides a path of least resistance for electric current to reduce the risk of electric shock. This tool is equipped with an electric cord having an equipment-grounding conductor and a grounding plug. The plug must be plugged into a matching outlet that is properly installed and grounded in accordance with all local codes and ordinances.
- Do not modify the plug provided – if it will not fit the outlet, have the proper outlet installed by a qualified electrician.
- Improper connection of the equipment-grounding conductor can result in a risk of electric shock. The conductor with insulation having an outer surface that is green with or without yellow stripes is the equipment-grounding conductor. If repair or replacement of the electric cord or plug is necessary, do not connect the equipment-grounding conductor to a live terminal.
- Check with a qualified electrician or service personnel if the grounding instructions are not completely understood, or if in doubt as to whether the tool is properly grounded.
- Use only 3-wire extension cords that have 3-prong grounding plugs and 3-pole receptacles that accept the tool's plug.
- Repair or replace damaged or worn cord immediately.
- This machine is intended for use on a circuit that has an outlet that looks like the one illustrated in Sketch A in Figure 82.1. The tool has a grounding plug that looks like the plug illustrated in Sketch A in Figure 82.1. A temporary adapter, which looks like the adapter illustrated in Sketches Band C, may be used to connect this plug to a 2-pole receptacle as shown in Sketch B if a properly grounded outlet is not available. The temporary adapter should be used only until a properly grounded outlet can be installed by a qualified electrician. The green-colored rigid ear, lug, and the like, extending from the adapter must be connected to a permanent ground such as a properly grounded outlet box.

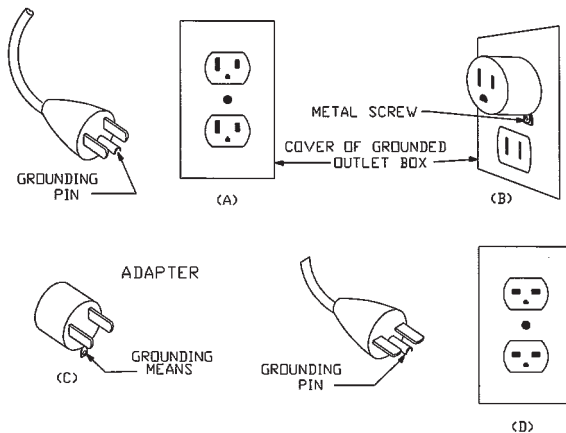

Figure 82.1  
Grounding methods

## Machine label for Tormek T-2



**Warning: Do not expose the machine to rain and do not use in damp places.**

### After the Work

- Never leave the machine running unattended.
- Store the machine in a locked room and out of reach of children and unauthorized persons.

### Sound Level

- Idling (no load): 54 dB(A)
- Grinding: 62.5 dB(A)
- Honing and polishing: 61 dB(A)

### Spare Parts and Repairs

The machine complies with the relevant safety rules. Repairs should only be carried out by qualified persons using original spare parts, otherwise this may result in considerable danger for the user.

### Spare part list

See page 34.

## Tormek warranty

The Tormek warranty covers all parts in your Tormek T-2 against material and/or manufacturing defects. The Tormek warranty guarantees the function of your machine but does not cover normal wear and tear, incorrect use or neglect. The warranty does not include freight costs. Valid together with the purchase receipt.

In the event that your Tormek T-2 needs service – contact us, see below. In many cases the problem can be solved over the phone or by sending a spare part. Do not return the machine without an agreement with your Tormek dealer.

Tormek AB, Torphyttvägen 40, SE-711 34 Lindesberg  
 Tel. +46 581 147 90, E-mail: [support@tormek.se](mailto:support@tormek.se)



Spare part list

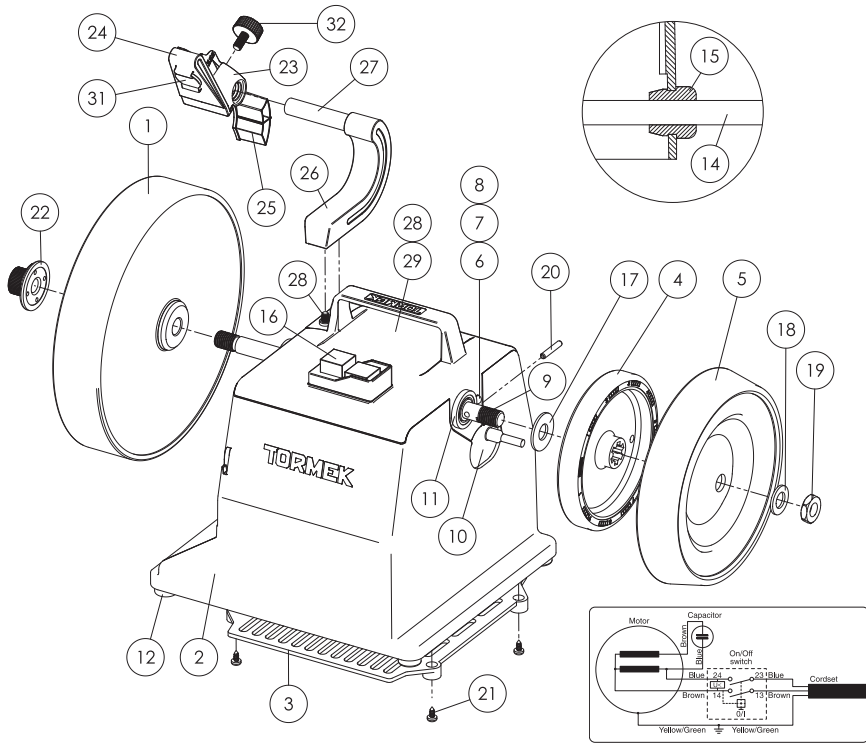

No.	Denomination	Qty	Art.no.
1	Grinding wheel	1	6078
2	Housing	1	3020 (230V) 3060 (115V)
3	Grating	1	3185
4	Drive wheel with friction ring	1	3208-07 (230V) 3186-07 (115V)
5	Honing wheel	1	3670-07
6	Mounting shaft	1	1400
7	* Bushing for mounting shaft	3	3128
8	* Distance spring for the motor	1	0770
9	Main shaft	1	1048
10	Motor 120 W	1	6168 (230V) 6010 (115V)
11	Nylon bearing	2	3061
12	Rubber foot	4	3198
13	* Machine label	1	7750 (SE/EN) 7770 (EN/FR)
14	Cord set	1	6031 (SE) 6041 (CH) 6043 (US) 6050 (JP) 6053 (GB) 6055 (AU) 6057 (ZA)

No.	Denomination	Qty	Art.no.
15	Strain relief	1	6081 (230V) 6191 (115V)
16	Switch	1	6320 (230V) 6330 (115V)
17	Washer for the drive wheel	1	5081
18	Washer for the honing wheel	1	5350
19	Nut M12 h=6	1	1051
20	Locking pin	1	5071
21	Screw for grating	4	5191
22	EzyLock	1	3520
23	Jig	1	2480
24	Clamp	1	3690
25	Pointer	1	3680
26	Axis holder	1	2490
27	Axis	1	1420
28	Screw M5x10	6	2430
29	Machine head	1	2440
30	* Screw M4x8	2	5600
31	Magnet	1	5370
32	Locking screw	1	1185

Weight machine only: 6.3 kg (13.9 lbs)

\* Not shown on drawing