

# Panel Max Glue Press Instructions

Gluing up panels of stock has never been easier than with the Panel Max Glue Press system! Unlike pipe or bar clamps which tend to overtighten and sometimes misshape your stock, the Panel Max applies pressure on all four sides of the work piece, ensuring a flat uniform surface every time.

**CAUTION:** Make sure the power supply is disconnected on your power tool(s) or machinery before making any adjustments. Don't use any tools with out the proper safety guard(s) in place or without reading the instruction manual that came with the unit. Always wear the proper eye, ear and respiratory equipment when using power tools.



## Before Assembly of The Panel Max Can Begin...

1. Cut a piece of lumber - that is 4" x 3" and at least as long as the Panel Max Slide Rail.
2. Cut a piece of lumber - that is 4" x 2½" and at least as long as the Panel Max Slide Rail.
3. Mount the 4" x 3" piece - to the base of your wall, making sure the piece is positioned parallel to the floor.
4. Mount the 4" x 2½" piece - to your wall 41" on center from the floor. This will provide a stable surface to mount the Panel Max Slide rail.
5. Attach the Slide Rail - to 4" x 2½" piece of stock (top piece) using 3 wood screws.

*Note: The 4" side on both lumber piece's are to be placed against the wall when mounting.*

## Assembly of The Panel Max

### Parts Diagram

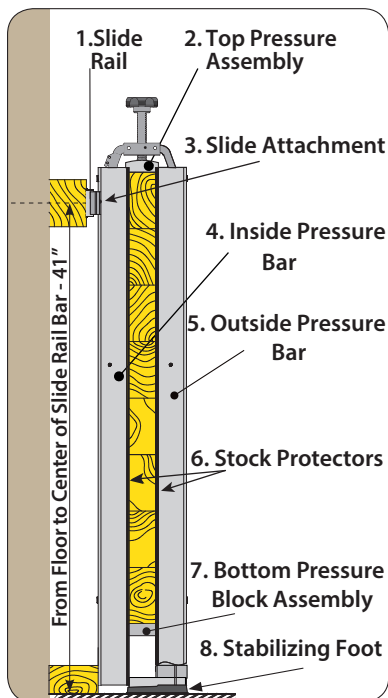

1. Attach the stock protectors on to all of the side pressure bars (Parts Diagram #6)
2. Insert the Bottom Pressure Block Assembly (Parts Diagram #7) to the one Inside Pressure Bar that will be mounted to the wall (Fig. A1). Slide the bottom pressure block about half way down the Inside Pressure bar.
3. Insert large black plastic washer into the inside of the Slide of the Pressure Bar. Screw the Slide attachment (Parts Diagram #3) onto the inside of the Inside Pressure Bar from the inside of the bar (Fig. A2). Do not fully tighten the screw, This will be adjusted later. *Note: The Slide attachment should be in the second square hole from the top of the Inside Pressure Bar.*
4. Temporarily slide the Stabilizing Foot (Parts Diagram #8) with the tapered end facing in into the bottom of the Inside Pressure Bar to insure proper height (Fig. A3).
5. Install the slide attachment (Parts Diagram #3) onto the slide rail (Parts Diagram #1) Once installed onto the slide rail you can now tighten up the screw that holds the slide attachment. Remove stabilizing foot from the Inside Pressure Bar. The Inside Slide Pressure Bar is now installed to the wall.
6. Slide the Outside Slide Pressure Bar (Part Diagram #5) onto the Bottom Pressure Block Assembly to connect the two pressure bars (Fig. A4). Place the Outside Pressure Bar into the Stabilizing Foot with the tapered end facing out (Fig. A5).
7. Install the Top Pressure Assembly into the two Side Pressure Bars from the top side as shown in (Fig. A6). The Top Pressure Assembly should only be used in the top two holes. The Plastic Fitting is designed to clip onto top edge of the inside slide pressure bar when the Panel Max is open while placing wooden boards into the glue press.
8. Repeat steps 1-7 for the rest of the side pressure bars.

Figure A1

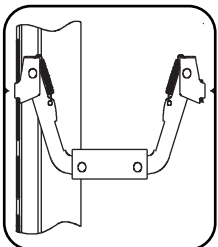

Figure A2

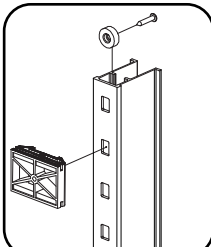

Figure A3

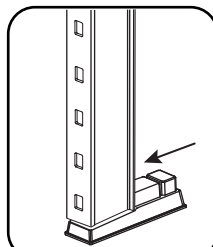

Figure A4

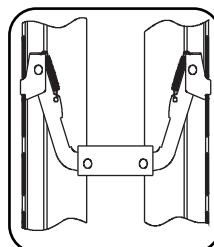

Figure A5

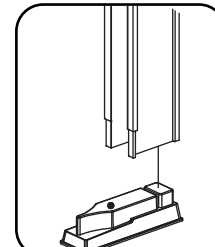
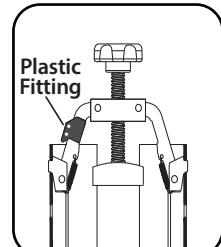

Figure A6



## General Usage of The Panel Max System

Fig. B

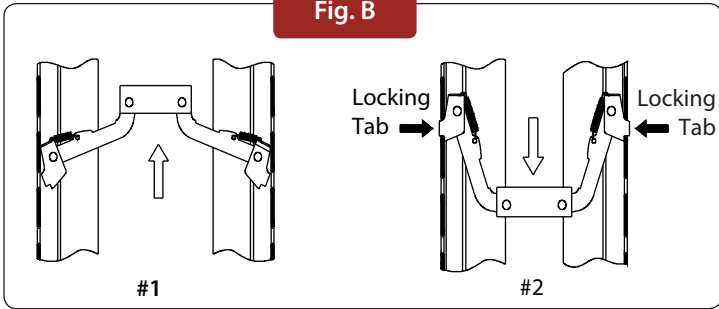
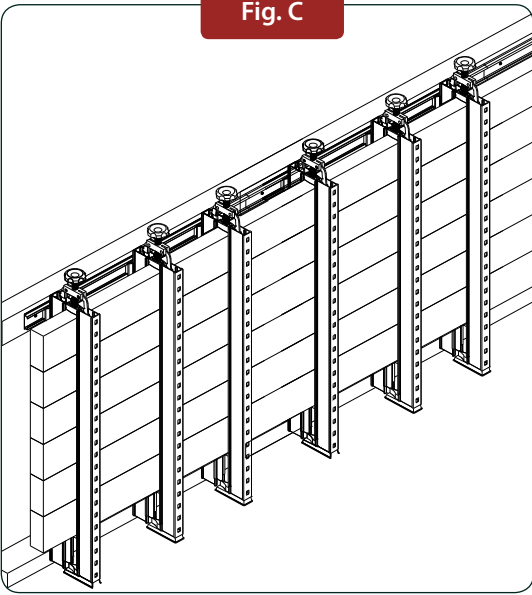

Fig. C



- The **Bottom Pressure Block Assembly** can be adjusted to any desired height depending on the width of you stock to be glued.
- To adjust the **Bottom Pressure Block Assembly for Narrow Stock** simply lift up on the center of the assembly to your desired height (Fig. B1) and release it when Locking Tabs are aligned with the square hole to secure in place.
- To adjust the **Bottom Pressure Block Assembly for Wider Stock** press in the locking tabs to lower (Fig. B2) and pull down to your desired height aligning Locking Tabs to square holes and secure in place.
- **Insert the wooden boards** one piece at a time. Once all your pieces are in the glue press and the bottom Pressure Block Assembly is set to the correct height, secure the wood pieces by turning the knob on the Top Pressure Assembly.
- **When raising or lowering the Bottom Pressure Block Assembly** make sure the Locking Tabs are locked securely in the same height square holes on all front and back Pressure Bars.

- **Expandable** - You can attach as many Slide Rail's side by side to achieve any length needed. Extra Rails and Side Pressure Bars are available for purchase Fig. C).

## General Panel Max System Maintenance

- When not in use, push the Side Pressure Bars together to avoid accidentally bumping into them.
- The threads on the Top Pressure Assembly should be lightly greased from time to time.
- Do your best to keep any glue from getting on any of the Panel Max Parts. If glue does get on the Panel Max System, clean the glue off as soon as possible.

## Technical Specs

- Stock Thickness (in between Side Pressure Elements) .....0" to 5" thick.
- Actual Gluing Height (panel height).....33" to 39"
- Approximate Gluing or Clamping Pressure.....1725 lbs