



Performance Scroll Saw  
Performance Dekupiersäge  
Performance Scie à chantourner  
Performance Sierra de calar

## Manuel d'utilisation / Instruction Manual / Handbuch



**SCF22CE-FLASH**

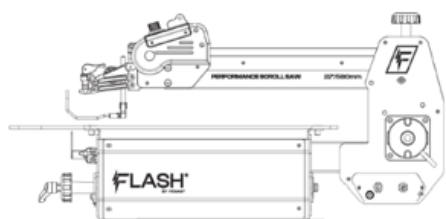

22" / 560 mm

**SCF16CE-FLASH**

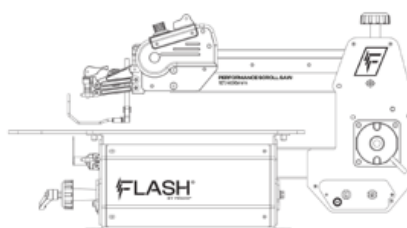

16" / 406 mm

A branded product of:

**SCIES** *MINIATURES* SÀRL  
swiss precision saw blades since 1966

[www.scies.ch](http://www.scies.ch)

Made in PRC

## TABLE OF CONTENTS

Specifications.....	2
Safety.....	3 - 6
Key Parts Overview .....	7
Attachment Parts.....	8
Assembly.....	8, 9
Adjustments.....	9 - 12
Operation.....	10 - 12
Maintenance.....	13

## SPECIFICATIONS

<b>Input</b>	<b>230-240V/50Hz, S1 80W S2 15min 120W</b>
<b>No Load Speed</b>	<b>400-1550 r/min(RPM)</b>
<b>Table Size</b>	<b>505x340mm / 650x350 mm</b>
<b>Cutting tilting</b>	<b>Left 0°- 30°,Right 0°- 45°</b>
<b>Saw blade length</b>	<b>130mm</b>
<b>Max cutting depth</b>	<b>50mm</b>

## SAFETY INSTRUCTIONS

### WARNING

Read all safety warnings and all instructions. Failure to follow the warnings and instructions may result in electric shock, fire and/or serious injury.

### WORK AREA SAFETY

1. **Keep work area clean and well lit.** Cluttered or dark areas invite accidents.
2. **Do not operate power tools in explosive atmospheres, such as in the presence of flammable liquids, gases or dust.** Power tools create sparks which may ignite the dust or fumes.
3. **Keep children and bystanders away while operating a power tool.** Distractions can cause you to lose control.

### ELECTRICAL SAFETY

1. **Power tool plugs must match the outlet. Never modify the plug in any way. Do not use any adapter plugs with earthed (grounded) power tools.** Unmodified plugs and matching outlets will reduce risk of electric shock.
2. **Avoid body contact with earthed or grounded surfaces such as pipes, radiators, ranges and refrigerators.** There is an increased risk of electric shock if your body is earthed or grounded.
3. **Do not expose power tools to rain or wet conditions.** Water entering a power tool will increase the risk of electric shock.
4. **Do not abuse the cord. Never use the cord for carrying, pulling or unplugging the power tool. Keep cord away from heat, oil, sharp edges or moving parts.** Damaged or entangled cords increase the risk of electric shock.
5. **When operating a power tool outdoors, use an extension cord suitable for outdoor use.** Use of a cord suitable for outdoor use reduces the risk of electric shock.
6. **If operating a power tool in a damp location is unavoidable, use a ground fault circuit interrupter (GFCI) protected supply.** Use of a GFCI reduces the risk of electric shock.

### PERSONAL SAFETY

1. **Stay alert, watch what you are doing and use common sense when operating a power tool. Do not use a power tool while you are tired or under the influence of drugs, alcohol or medication.** A moment of inattention while operating power tools may result in serious personal injury.
2. **Use personal protective equipment. Always wear eye protection.** Protective equipment such as a respiratory mask, non-skid safety shoes and hearing protection used for appropriate conditions will reduce the risk of personal injury.
3. **Prevent unintentional starting. Ensure the switch is in the off-position before connecting to power source and/or battery pack, picking up or carrying the tool.** Carrying power tools with your finger on the switch or energizing power tools that have the switch on invites accidents.
4. **Remove any adjusting key or wrench before turning the power tool on.** A wrench or a key left attached to a rotating part of the power tool may result in personal injury.

## SAFETY INSTRUCTIONS

5. **Do not overreach.** Keep proper footing and balance at all times. This enables better control of the power tool in unexpected situations.
6. **Dress properly. Do not wear loose clothing or jewelry. Keep your hair and clothing away from moving parts.** Loose clothes, jewelry or long hair can be caught in moving parts.
7. **If devices are provided for the connection of dust extraction and collection facilities, ensure these are connected and properly used.** Use of dust collection can reduce dust-related hazards.

### POWER TOOL USE AND CARE

1. **Do not force the power tool. Use the correct power tool for your application.** The correct power tool will do the job better and safer at the rate for which it was designed.
2. **Do not use the power tool if the switch does not turn it on and off.** Any power tool that cannot be controlled with the switch is dangerous and must be repaired.
3. **Disconnect the plug from the power source and/or the battery pack from the power tool before making any adjustments, changing accessories, or storing power tools.** Such preventive safety measures reduce the risk of starting the power tool accidentally.
4. **Store idle power tools out of the reach of children and do not allow persons unfamiliar with the power tool or these instructions to operate the power tool.** Power tools are dangerous in the hands of untrained users.
5. **Maintain power tools. Check for misalignment or binding of moving parts, breakage of parts and any other condition that may affect the power tool's operation. If damaged, have the power tool repaired before use.** Many accidents are caused by poorly maintained power tools.
6. **Keep cutting tools sharp and clean.** Properly maintained cutting tools with sharp cutting edges are less likely to bind and are easier to control.
7. **Use the power tool, accessories and tool bits, etc. in accordance with these instructions, taking into account the working conditions and the work to be performed.** Use of the power tool for operations different from those intended could result in a hazardous situation.
8. **Use clamps to secure your workpiece to a stable surface.** Holding a workpiece by hand or using your body to support it may lead to loss of control.
9. **KEEP GUARDS IN PLACE** and in working order.

### SERVICE

1. **Have your power tool serviced by a qualified repair person using only identical replacement parts.** This will ensure that the safety of the power tool is maintained.
-

## SAFETY INSTRUCTIONS

### BEFORE OPERATION

1. Check for both proper assembly and proper alignment of moving parts.
2. Understand the proper use of the ON / OFF switch.
3. Know the condition of the scroll saw. If any part is missing, bent, or does not operate properly, replace the component before attempting to operate the scroll saw.
4. Determine the type of work you are going to be doing. Properly protect your body including your eyes, hands, face, and ears.
5. To avoid injury caused by pieces thrown from accessories, use only recommended accessories designed for this saw. Follow the instructions supplied with the accessory. The use of improper accessories may cause risk of injury.
6. **To avoid contact with rotating equipment:**
  - Do not put your fingers in a position where they risk contacting the blade if the workpiece unexpectedly shifts or your hand unexpectedly slips.
  - Do not cut a workpiece too small to be held safely.
  - Do not reach under the scroll saw table when the motor is running.
  - Do not wear loose clothing or jewelry. Roll long sleeves above the elbow. Tie back long hair.
7. To avoid injury from accidental startups of the scroll saw:
  - Make sure to turn OFF the switch and unplug the power cord from the electric outlet before changing the blade, performing maintenance or making adjustments.
  - Make sure the switch is OFF before plugging in the power cord to an electric outlet.
8. To avoid injury from a fire hazard, do not operate the scroll saw near flammable liquids, vapors or gases.
9. **To avoid back injury:**
  - Obtain help when raising the scroll saw more than 10 inches (25.4 cm). Bend your knees when lifting the scroll saw.
  - Carry the scroll saw by its base. Do not move the scroll saw by pulling on the power cord. Pulling on the power cord could cause damage to the insulation or the wire connections resulting in electric shock or fire.

### SCROLL SAW SAFETY

1. **To avoid injury from unexpected saw movement:**
  - Use the scroll saw on a firm level surface with adequate space for handling and supporting the workpiece.
  - Be sure the scroll saw cannot move when operated. Secure the scroll saw to a workbench or table with wood screws or bolts, washers and nuts.

## SAFETY INSTRUCTIONS

### SCROLL SAW SAFETY - CONTINUED FROM PAGE 5

2. **Before moving the scroll saw, unplug the power cord from the electrical outlet.**

3. **To avoid injury from kickback:**

- Hold the workpiece firmly against the tabletop.
- Do not feed the workpiece too fast while cutting. Only feed the workpiece at the rate the saw will cut.
- Install the blade with the teeth pointing downward.
- Do not start the saw with the workpiece pressing against the blade. Slowly feed the workpiece into the moving blade.
- Use caution when cutting round or irregularly shaped workpieces. Round items will roll and irregularly shaped workpieces can pinch the blade.

4. **To avoid injury when operating the scroll saw:**

- Obtain advice from a qualified person if you're not thoroughly familiar with the operation of scroll saws.
- Before starting the saw, make sure the blade tension is correct. Recheck and adjust tension as needed.
- Make sure the table is locked into position before starting the saw.
- Do not use dull or bent blades.
- When cutting a large workpiece, make sure the material is supported at the table height.
- Turn the saw OFF and unplug the power cord if the blade jams in the workpiece. This condition is usually caused by sawdust clogging the line you are cutting. Wedge open the workpiece and back out the blade after turning off and unplugging the machine.

### GROUNDING INSTRUCTIONS

**In the event of a malfunction or breakdown**, grounding provides the path of least resistance for an electric current and reduces the risk of electric shock. This tool is equipped with an electric cord that has an equipment grounding conductor and a grounding plug. The plug **MUST** be plugged into a matching outlet that is properly installed and grounded in accordance with ALL local codes and ordinances.

1. **Do not modify the plug provided.** If it will not fit the outlet, have the proper outlet installed by a licensed electrician.
2. **Improper connection** of the equipment grounding conductor can result in electric shock. The conductor with the green insulation (with or without yellow stripes) is the equipment grounding conductor. If repair or replacement of the electric cord or plug is necessary, **DO NOT** connect the equipment grounding conductor to a live terminal.
3. **Check** with a licensed electrician or service personnel if you do not completely understand the grounding instructions or whether the tool is properly grounded.
4. **Use only three-wire extension cords** that have three-pronged plugs and outlets that accept the tool's plug. Repair or replace a damaged or worn cord immediately.

**CAUTION!** In all cases, make certain the outlet in question is properly grounded. If you are not sure, have a licensed electrician check the outlet.

## KEY PARTS OVERVIEW

No.	Description	Qty.
1	Blade tension knob	1
2	Power switch	1
3	Variable speed control knob	1
4	Blade tension handle	1
5	Blade lock knob	2
6	Blade guard	1
7	Sawdust blower	1
8	Work table	1
9	Table level lock handle	1
10	Table level knob	1
11	18 TPI Pinless Blade	1
12	Motor	1
13	Pull ring pin	1

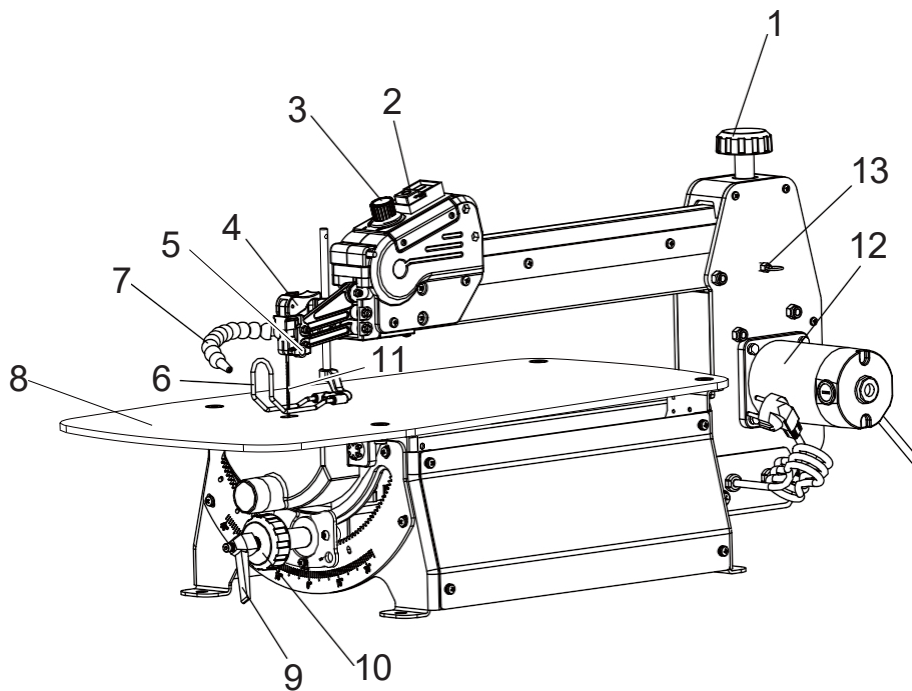

## ATTACHMENT PARTS

No.	Description	Qty.
1	Dust hood	1
2	Phillips screw M4X12	2
3	90° Dust hose fitting	1
4	Pégas Reverse Blade MGT 7	1
5	Hex Wrenches (S3, S4)	2

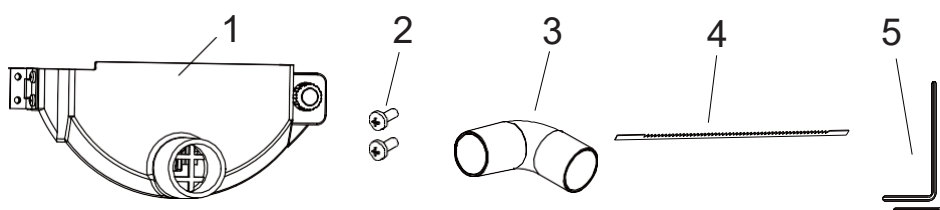

See pages 16 to 18 for the Parts Diagram and Parts List.

## ASSEMBLY

### UNPACKING AND CLEAN-UP

1. **⚠ WARNING** Report any shipping damage immediately to your local distributor. Take photographs for any possible insurance claims.
  
2. Carefully remove all contents from the shipping carton. Compare the contents with the list of contents to make sure that all of the items are accounted for, before discarding any packing material. Place parts on a protected surface for easy identification and assembly.  
 If any parts are missing or broken, please call RIKON Customer Service (877- 884-5167) as soon as possible for replacements. DO NOT turn your machine ON if any of these items are missing. You may cause injury to yourself or damage to the machine.
  
3. Clean all rust protected surfaces with ordinary house-hold type grease / spot remover or mild solvent. Do not use; gasoline, paint thinner, mineral spirits, etc. These may damage painted surfaces. Wipe all parts thoroughly with a clean dry cloth.
  
4. Set packing material and shipping carton aside. Do not discard until the machine has been set up and is running properly. Dispose of the packing in an environmentally friendly manner.

## ASSEMBLY & ADJUSTMENTS

This machine is designed to operate in closed rooms and must be placed stable on a firm and level surface. For safe operation of the scroll saw, the machine should be secured to a solid work surface, bench or stand.

- A workbench made from solid wood is better than one made of plywood, as interfering vibrations and noise are more noticeable with plywood.

**⚠ WARNING** THE MACHINE MUST NOT BE PLUGGED IN AND THE POWER SWITCH MUST BE IN THE 'OFF' POSITION UNTIL ASSEMBLY IS COMPLETE.

### TO REDUCE RISK OF INJURY:

- When carrying the saw, hold it close to your body to avoid injury to your back. Bend your knees when lifting the saw.
- Carry the saw by the base, table or housing. DO NOT carry the saw by the upper arm, motor or power cord.
- Secure the saw in a position where people cannot stand, sit, or walk behind it. Debris thrown from the saw could injure people standing, sitting, or walking behind it. Secure the saw on a firm, level surface where the saw cannot rock. Make sure there is adequate room for handling and properly supporting the workpiece.

### DUST COVER INSTALLATION

1. Secure the dust hood to the machine by threading the Phillips screws (Fig. 1, 1) through the holes in the hinge.
2. Tighten the locking knob (2).

Note: This machine is equipped with a 90° elbow for easy dust hose fitting. See page 9.

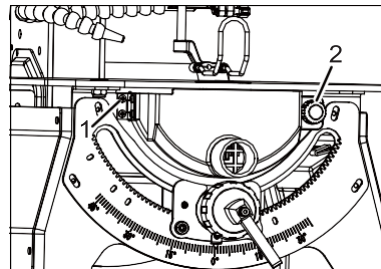

FIGURE 1

### ALIGN THE BEVEL INDICATOR

The bevel indicator has been adjusted at the factory, but should be rechecked prior to use for best operation.

1. Loosen the blade guard knob (Fig. 2, 1) and move the blade guard (2) all the way up.
2. Check if the pointer is on the 0 scale. If not, first Loosen the table level lock handle (Fig. 3, 3) and turn the table level knob (4) to bevel the table until it is approximately at a right angle to the blade.

## ADJUSTMENTS & OPERATION

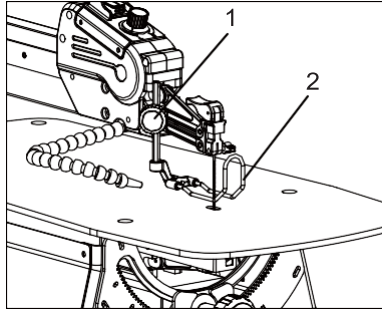

FIGURE 2

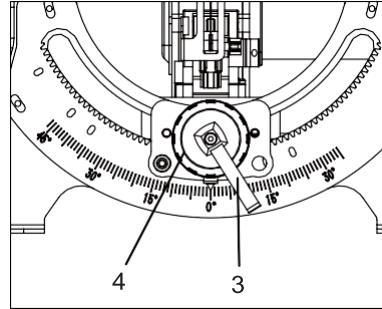

FIGURE 3

### ADJUSTING THE DUST BLOWER

For best results, the dust blower tube (Fig. 4, 3) should be adjusted to direct air at both the blade and the workpiece.

### POWER SWITCH & SPEED CONTROL KNOB

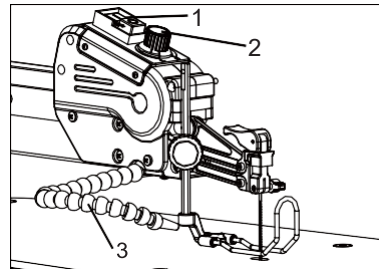

FIGURE 4

1. To turn the saw on, flip the I/O switch (Fig. 4, 1) to I. When first starting the saw, it is best to move the speed control knob (2) to the middle speed position.
2. Turning the control knob. Turning it towards H increases speed; turning it towards L reduces speed.
3. To turn the saw off, flip the I/O switch back to O.

### **⚠**WARNING

To avoid injury from accidental start-ups, always turn the switch OFF and unplug the scroll saw before moving the saw, replacing the blade, or making adjustments.

### FREEHAND CUTTING

1. Lay out desired design, or secure design to the workpiece.
2. Raise the blade guard foot by loosening the height adjustment knob.
3. Position the workpiece against the blade and place the blade guard foot just above the top surface of the workpiece.
4. Secure the blade guard foot by tightening the height adjustment knob.
5. Remove the workpiece from the blade prior to turning the scroll saw ON.
6. Slowly feed the workpiece into the blade while holding the workpiece securely against the table.
7. When cutting is complete, move trailing edge of the workpiece beyond the blade guard foot. Turn the switch OFF.

## ADJUSTMENTS & OPERATION

### ANGLE CUTTING (BEVELING)

1. Layout or secure design to workpiece.
2. Loosen the blade guard height adjustment knob (Fig. 5, 2), move the blade guard foot (1) to the highest position, and retighten the knob.
3. Tilt the table to the desired angle by loosening the table bevel lock knob (3). Move the table to the proper angle using the degree scale and the pointer (4).

TIP: The table has positive stops at 0, 22.5, 30, and 45 degrees.

4. Tighten the table bevel lock knob (Fig. 5, 3).
5. Loosen the blade guard rear screw (Fig. 6, 3), and tilt the blade guard to the same angle as the table. Retighten the blade guard screw.
6. Position the workpiece on the right side of the blade. Lower the blade guard foot against the surface by loosening the height adjustment knob. Retighten.
7. Follow steps 5 to 7 under Freehand Cutting on page 11.

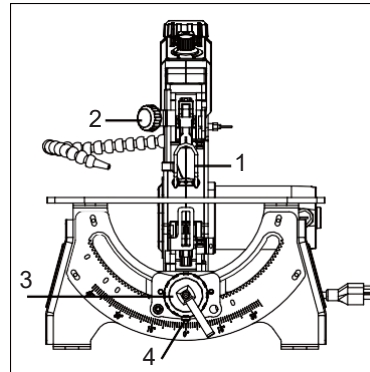

FIGURE 5

### INTERIOR CUTTING & FRETWORK

1. Lay out your design on the workpiece. Drill a 1/4" pilot hole in the workpiece.
2. Rotate the Blade tension handle (Fig. 6, 1) up. Loosen the top blade locking knob (2).
3. Gently lift the upper arm (Fig. 7, 3) of the saw.
4. Place the workpiece on the saw table, threading the blade through the hole in the workpiece.
5. Gently lower the upper arm to return it to its initial position.
6. Pull the ring pin (Fig. 7, 4) outward, lower the upper arm. This will lock the upper arm in place. Gently press on the upper arm to make sure it is locked in place.
7. Secure the blade in the upper blade clamp, as directed in "Replace the Saw Blade" (see page 13).
8. Follow steps 4 - 7 under "Freehand Cutting".
9. When finished making the interior cuts, turn the scroll saw OFF and unplug it. Relieve blade tension and remove the blade from the upper blade clamp. Raise the upper arm and remove the workpiece. Lower the upper arm and lock it in place.

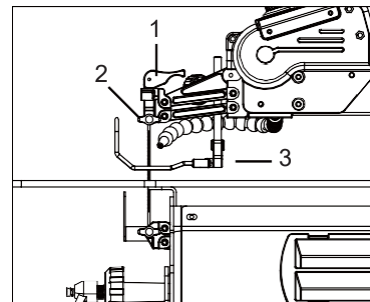

FIGURE 6

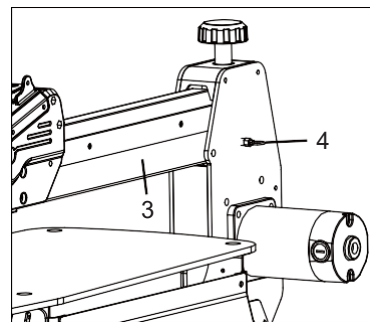

FIGURE 7

## ADJUSTMENTS & OPERATION

**⚠ WARNING** Make sure the saw is turned OFF and unplugged before making any adjustments to the blade.

**NOTE:** The 10-622VS 22" Scroll Saw only accepts 5" PINLESS scroll saw blades.

### REPLACE THE SAW BLADE

1. Loosen the locking knob (Fig.8, 1) first and swing open the Dust Hood (2).
2. To remove the blade, rotate the Blade Tension Handle (Fig. 9, 2) upward to relieve tension.
3. Loosen the top blade locking knob (3), then loosen the bottom blade locking knob (4).

Remove the blade.

4. With the blade's teeth facing toward you and pointing down, thread the new blade through the table slot so that its bottom rests in the bottom clamp.
5. Tighten the bottom blade locking knob (4). This locks the blade in place.
6. Insert the top of the blade into the top clamp. Tighten the top blade locking knob (3).
7. Pull down the Blade tension handle (2) toward down to Lock up.
8. Fine-tune the Blade tension knob (Fig. 10, 5).

TIP: A properly-tensioned blade will make a high-C sound (C6, 1047 Hz) when plucked with a finger.

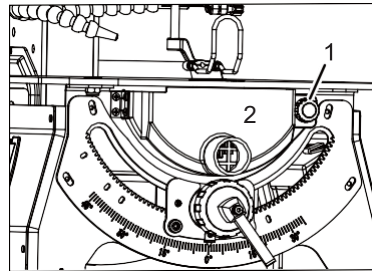

FIGURE 8

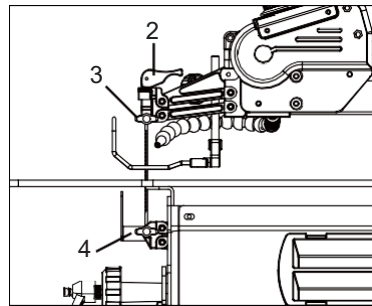

FIGURE 9

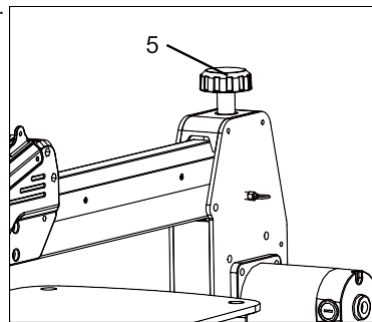

FIGURE 10

### IMPORTANT

For your own safety, read and follow all of the Safety Guidelines and Operating Instructions before using this machine.

## MAINTENANCE

### CARBON BRUSH REPLACEMENT

The wear on the carbon brushes depends on how frequently and how heavily the tool is used. To maintain maximum efficiency of the motor, we recommend inspecting the two carbon brushes every 60 hours of operation or when the tool stops working.

1. Unplug the saw. To access the carbon brushes, remove the carbon brush cover (Fig. 11, 1) with a flat-head screwdriver (not included).
2. Carefully remove the old carbon brushes. Keep track of which orientation the old carbon brushes were in to prevent unnecessary wear if they will be reinstalled.
3. Measure the length of the brushes. Install the new set of carbon brushes if either carbon brush length is worn down to  $19/32$ " or less. Reinstall the old carbon brushes (in their original orientation) if your brushes are not worn down to  $19/32$ " or less. Both carbon brushes should be replaced at the same time.
4. Replace the carbon brush cover.

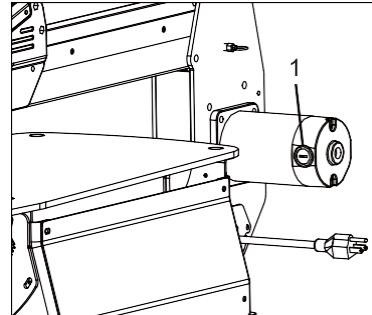

FIGURE 11

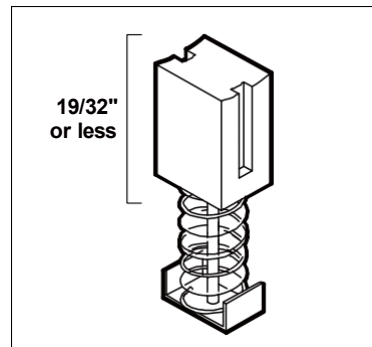

FIGURE 11

### GENERAL MAINTENANCE

1. Before each use:
  - Check the power cord and plug for any wear or damage.
  - Check for any loose screws or hardware.
  - Check the area to make sure it is clear of any misplaced tools, lumber, cleaning supplies, etc. that could hamper the safe operation of the machine.
2. Check the saw blade before use to make sure that it is properly installed, tensioned and not dull. Clean and efficient cutting results from a properly set blade.
3. Clean your saw after each use. Wipe it down with a soft cloth. Clean any accumulated sawdust out of the base. Use low-pressure compressed air (not to exceed 25 PSI) to blow any sawdust out of the blade holders, blade bevel rails, etc. **WARNING:** If blowing sawdust, wear proper eye protection to prevent debris from blowing into eyes.
4. If desired, apply a light coat of dry lubricant (such as PTFE) to the inside of the blade bevel rails. This will help the table bevel smoothly.
5. The motor bearings, interior bearings, and table bevel rail bearings are all sealed and require no additional lubrication.